

1

2

3

4

5

6

0

Quote dwg

Date 6/1/09

A

B

C

A

B

C



250ml Sample Bag X2

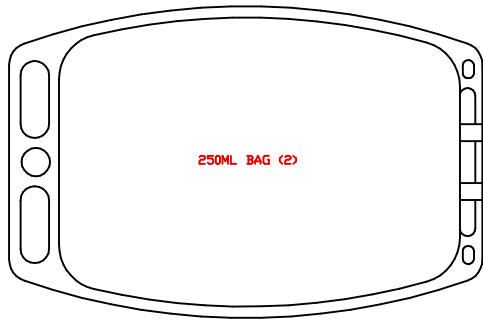

250ML BAG (2)

Spike Port X2

Slide Clamps X3

TPE (1/8x1/4x10L)

Y-Connector

Plug

TPE (1/8x1/4x10L)

Notes:

- 1. All connections cable tied.
- 2. Packaged individually.

Quote Drawing

Dimensional Tolerances
 All tubing dimension as specified.
 Fractional dimensions (+/- 1/16")
 0.0 (+/-0.1"), 0.00 (+/-0.05), 0.000(+/-0.005)

Optimum Processing Inc.

336 Bon Air Center #128
 Greenbrae, CA 94904
 ph: 415.722.5747

2x 250ml Bag Assy.

SIZE SCALE Third angle projection

A

NTS

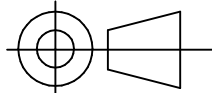

Drw: DM Smith

Date 6/1/09

This specification contains proprietary information. No reproduction of this document is allowed without approval or consent of Optimum Processing Inc.

**2X 250ml Sample Bag
 Assembly with Spike Ports**

Rev
0

1

2

3

4

5

6